

4 ft. Deco Grid Install

Note: Clamps and Hardware are inside posts. Remove parts from the bottom of post.

Required Tools for Deco Grid System Install

Hammer, tape measure, chalk or marker, shovel, post hole digger, wheel barrow, adjustable wrench, M8 hex key, hack saw, rotary cutting tool or bolt cutting tool, electric drill, 1/16 in., 5/16 in. & 3/8 in. drill bits. Masonry drill bits, anchors and additional hardware may be needed to install flange posts.

1. Install Posts

Use in-ground post when installing in ground with concrete. Use flange post when surface mounting on concrete or wood.

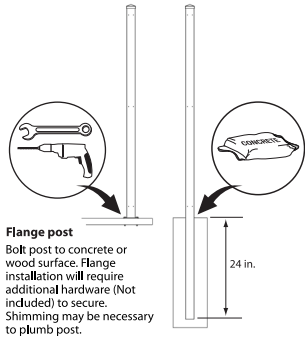

In-ground post

Dig holes for post approximately 8 inches in diameter and 24 to 30 inches deep. The depth will be determined by local codes/weather zones. Mark the ground line on posts with marker or chalk. Installed post height should be 49-1/2 in. Post must be plumb. Fill hole with continuous pour of concrete. Trowel the top so it slopes away for the post for water run off.

Flange post

Bolt post to concrete or wood surface. Flange installation will require additional hardware (Not included) to secure. Shimming may be necessary to plumb post.

2. Measure Gate Opening

Posts for the gate opening must be set 48 in. apart, measured from center of post to center of post or 46 in. from inside edge to edge. Posts must be plumb. Let the concrete cure before you install gates or panels.

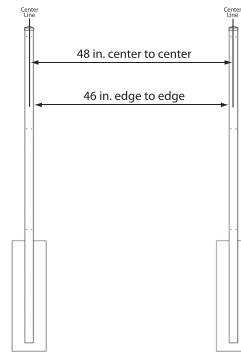

*Opening should be measured at the top and bottom to insure the spacing is parallel

3. Post Offset

Set the remaining posts at 72 in. on center or 70 in. inside to inside edge. Shorter spans must be in 1-7/8 inch intervals. See Step 7 for panel cutting. Washers are used when panel is mounted to one side only (end and corner post installation).

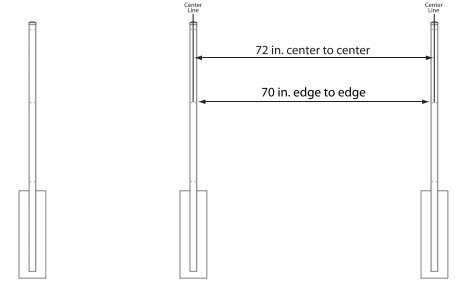

*Opening should be measured at the top and bottom to insure the spacing is parallel

4. Install First Panel

Mount panel to post with clamps, nuts and bolts. **NOTE:** Place the extending tab on the clip in the down position for install. It is only used in the upward position on a 90 degree corner.

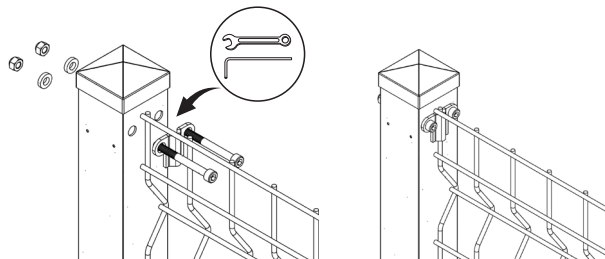

6. Corner Installation

Mount panel to corner post. Holes must be drilled in the post to mount a panel at a 90 degree angle. Dimples mark the spot to drill. **NOTE:** Flip the clip with the tab up on the side of the post that has been drilled. This will keep the fence panels in line and level.

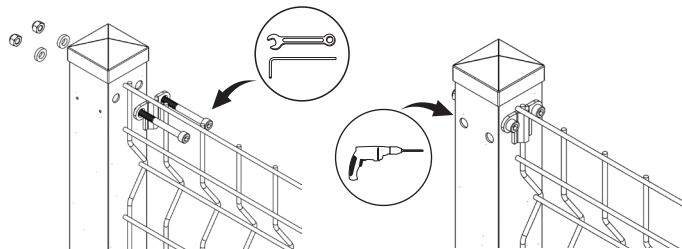

5. Continue Installing Panels

Mount 2 panels - Bolt through clamps on both sides of the post.

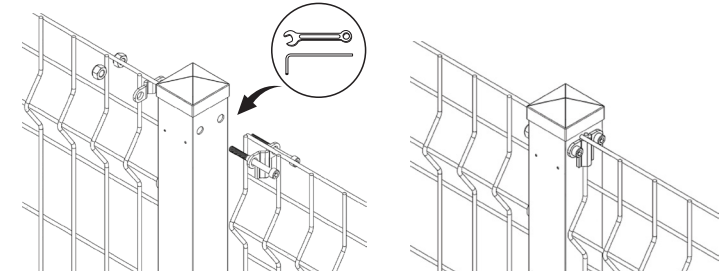

7. Cut Panel

If you are going to install a span less than 6 ft. The panel must be cut in 1-7/8 in. increments ending with vertical wire. Panel can be cut with rotary cutting tool, hack saw or bolt cutting tool. Touch up exposed steel on cut ends with rust inhibiting paint.

Caution: Use safety eye protection.
Caution: Cut edge may be sharp

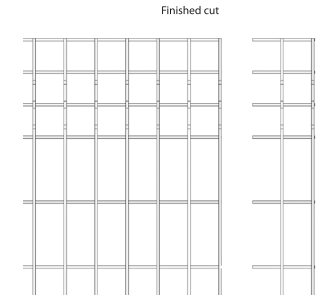

8. Installing Acute Angle Corners

If you want to install a corner that is less than a 90 degree corner you must measure the post placement from the face of the corner post, 70 in. between inside of posts. Mount the panel in the same fashion as shown in Step 6. The post must be drilled for this installation.

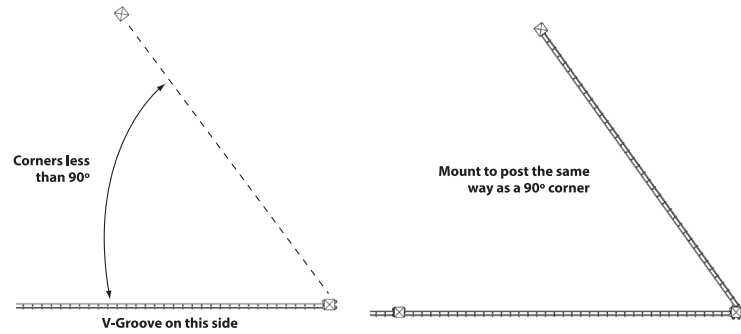

9. Installing Obtuse Angle Corners

If you want to install a corner that is greater than 90 degrees, measure the post placement from the side of the corner post, 70 in. between the insides of the posts. Mount the panel in the same fashion as if you were mounting the panel in a straight line, not like a corner installation. Note: Installation with multiple non-90 degree angles may require panel orientation to be reversed.

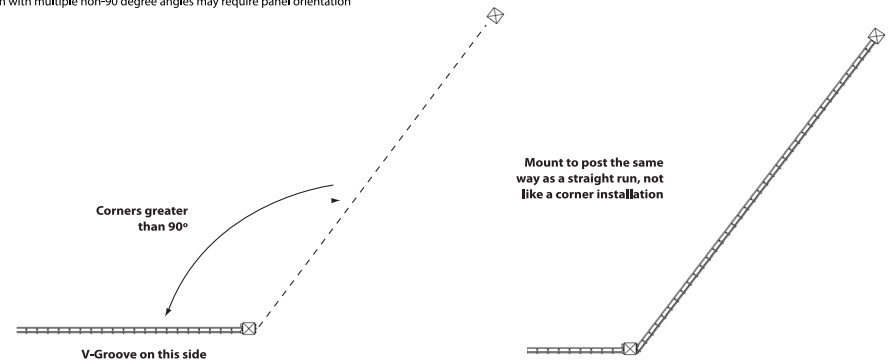

10. Gate Install

Start the gate installation by mounting the hinge to the post. The top hinge should measure 8.75" from bottom of post cap to bottom of hinge. The bottom hinge should measure 40.25" from bottom of post cap to bottom of hinge. Mount the hinge brackets to the post using the nuts and bolts provided. Next, mount the gate hinge to the gate using the pre-drilled holes. The top hinge should face upward and the bottom hinge downward. Install the gate by inserting the lower hinge into the bottom hinge bracket. Next, place the top hinge bracket on the top hinge and secure the hinge bracket to the post using the nuts and bolts provided.

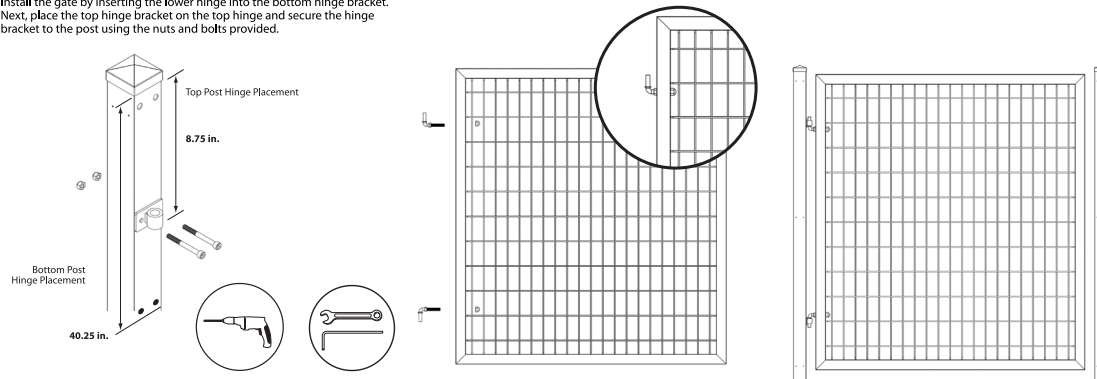

11. Latch Install

Pre-drill 1/16 in. pilot holes in the gate and mount the striker to the gate at the desired height using the self-tapping screws provided. Next, line up the latch on the post, drill the holes, and mount with the remaining self-tapping screws.

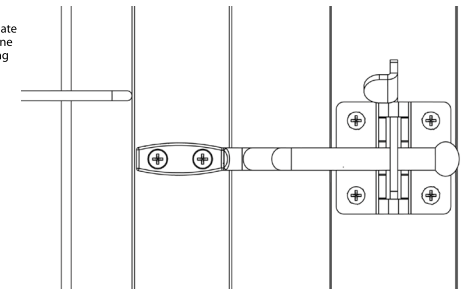

12. Stepped Installation/Grade

This fence is designed for use on level ground. To install on a slight grade, a stepped installation is recommended. To step the fence, set the posts not more than 5" higher than the previous post. The maximum post height is 54 1/2" above ground level.

Note: Flange posts cannot be used for stepped installation.

